

Cultivator Repair Parts

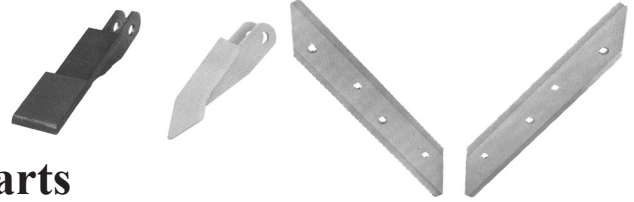

Ridge Till Cultivator Replacement Parts

Repair blades to fit Hiniker, Kinze, Buffalo, Krause, Sukup and others. Produced out of 5/16" thick x 3-1/2" wide. Double bevel, reversible. Sold each, without hardware. All points have a chrome carbide cap installed.

ORDER NO.	DESCRIPTION	WT.	OVERALL		RETAIL
			LENGTH	STOCK	
W4117HRB	Reversible blade, 17".	4	20 1/2	65316	\$19.37
W4119HRB	Reversible blade, 19".	5	22 1/8	30514	\$21.47
W4121HRB	Reversible blade, 21".	5	23 1/2	91614	\$23.13
W4125HRB	Reversible blade, 25".	7	27 3/8	74819	\$26.39
W4127HRB	Reversible blade, 27".	8	29	31025	\$28.76
WPOINT	Fits Hiniker, Buffalo, Krause, and Wetherell - Flat Point. Wiese number 41BMPH.	3		04615	\$23.43
WPOINTC	Eaglebeak point, fits Hiniker 6000 series only. Wiese part number 41WCP6.	2		92617	\$23.27
WPOINTC5	Eaglebeak point, fits Hiniker 5000 series only. Wiese part number 41WCP5.	2		77519	\$22.53
KIPB381	Plow bolts, 50 pcs with nuts, fits Rev. blades.		3/8" x 1"	49019	\$15.63

Stabilizer Coultter for Cultivators

Stabilizer coultter fits most popular row crop cultivators. Constructed of boron steel modified for longer wear life.

Replaces: Hiniker 805-001-001
 Wilrich Noble 605109F1 / 370581
 Kongskilde 01019125
 Wetherell W2047



Bolt Circle: 4" - 4 bolt.
 Bolt Hole: 17/32"
 Center Hole: 2 5/8"

ORDER NO.	DESCRIPTION	WT.	STOCK	RETAIL
WP18157	Stabilizer coultter, 18" x .157 thick (4.0 mm), 4 bolt.	10	51429	\$34.50

Cultivator Cutaway Disc

Coultter to fit Hiniker cultivator units. 11 ga material (3 mm).



ORDER NO.	DESCRIPTION	STOCK	RETAIL
P12HIN	Concave disc, 12" 5 bolt pattern. <i>** to be discontinued when current inventory is depleted.</i>	0488	\$12.00
P14HIN	Concave disc, 14" 5 bolt pattern. <i>** to be discontinued when current inventory is depleted.</i>	0897	\$14.00

Rims

ORDER NO.	DESCRIPTION	STOCK	RETAIL
H41210	Gauge Wheel Rim half for 4 x 12 assemblies, white metal. <i>** to be discontinued when current inventory is depleted.</i>	5138	\$4.50

Bearings for Cultivators

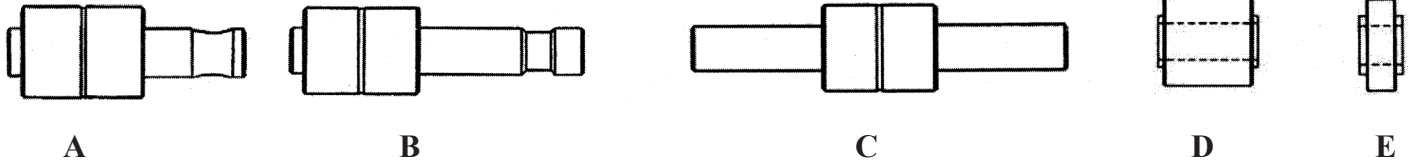

ITEM	ORDER NO.	DESCRIPTION	STOCK	RETAIL
A	B203001	Gauge wheel bearing; Noble, JD, MF. 2 13/16" x 1 3/16".	4046	\$5.77
B	H2003007	Gauge wheel bearing; Case, IHC, Glencoe. 3 3/4 x 1-3/16".	2475	\$10.60
C	B885151BOS2	Gauge wheel bearing; Noble, Glencoe. 5" x 1 3/16".	2474	\$10.60
D	H750	Gauge wheel bearing; JD, MF, Noble. 2 13/16" x 1 3/16".	5663	\$9.50
	HA25915	Bearing sleeve for all of the above.	1419	\$2.01
E	B203KRR2	Rotary Hoe bearing; John Deere, Yetter, etc.	0426	\$3.43

Sweeps for Row Crop Cultivators

Also used on AC field cultivators.

Made of super tough boron steel.

54 degree pitch, 7/16" bolt holes on 2" spacing.

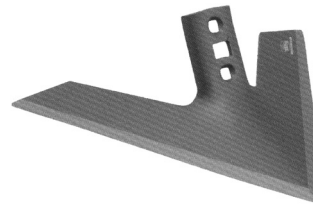

ORDER NO.	DESCRIPTION	STOCK	RETAIL
W1406	Row Crop Sweep, 1/4" x 6".	1164	\$8.73
W1407	Row Crop Sweep, 1/4" x 7".	6265	\$8.94
W1408	Row Crop Sweep, 1/4" x 8".	3378	\$10.47
W1409	Row Crop Sweep, 1/4" x 9".	4578	\$10.77
W1410	Row Crop Sweep, 1/4" x 10".	6771	\$11.09
W1412	Row Crop Sweep, 1/4" x 12".	74015	\$14.96
W1414	Row Crop Sweep, 1/4" x 14".	16516	\$22.30
W1416	Row Crop Sweep, 1/4" x 16".	16518	\$22.30
W1418	Row Crop Sweep, 1/4" x 18".	02814	\$26.00
W1420	Row Crop Sweep, 1/4" x 20".	02815	\$26.00
W1422	Row Crop Sweep, 1/4" x 22".	06919	\$28.00
W1424	Row Crop Sweep, 1/4" x 24".	06917	\$28.00

Ordering Info: Half sweeps are also available at a cost of \$1.00 more per sweep, they will be plasma torched from a full sweep.